

AREA CALCULATION					
AREA MKD.	A	B	C	S = (A+B+C)/2	AREA IN SQ.M.
A	68.253	65.337	16.977	75.28	554.03
B	65.337	45.974	57.176	84.24	1284.47
C	45.974	38.754	21.708	53.22	419.17
D	37.777	35.665	15.032	44.24	267.46
E	37.777	37.24	57.176	66.10	694.14
F	5.752	8.56	9.949	12.13	24.56
G	9.949	32.556	37.24	39.87	151.59
H	6.974	33.851	32.556	36.70	113.12
I	32.625	33.851	14.786	40.63	238.46
TOTAL					3747.01

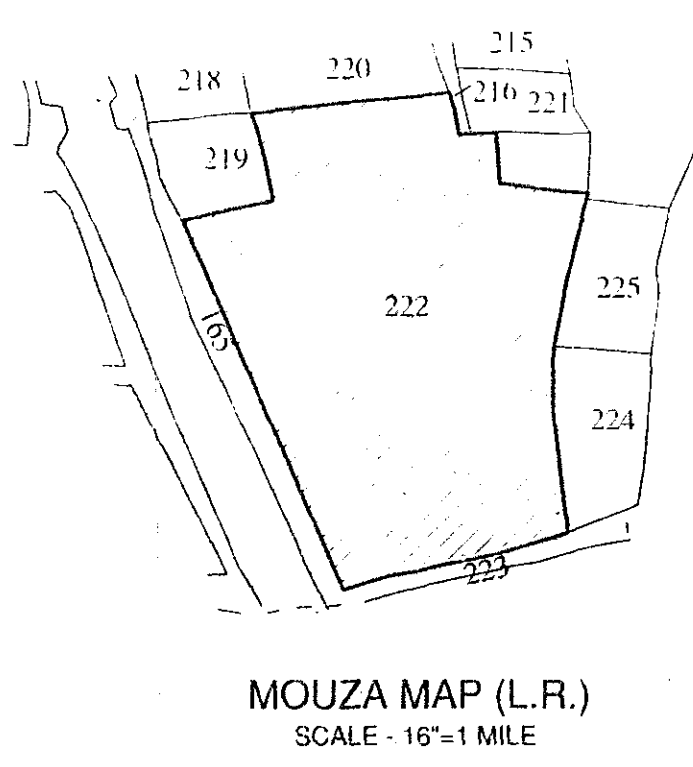
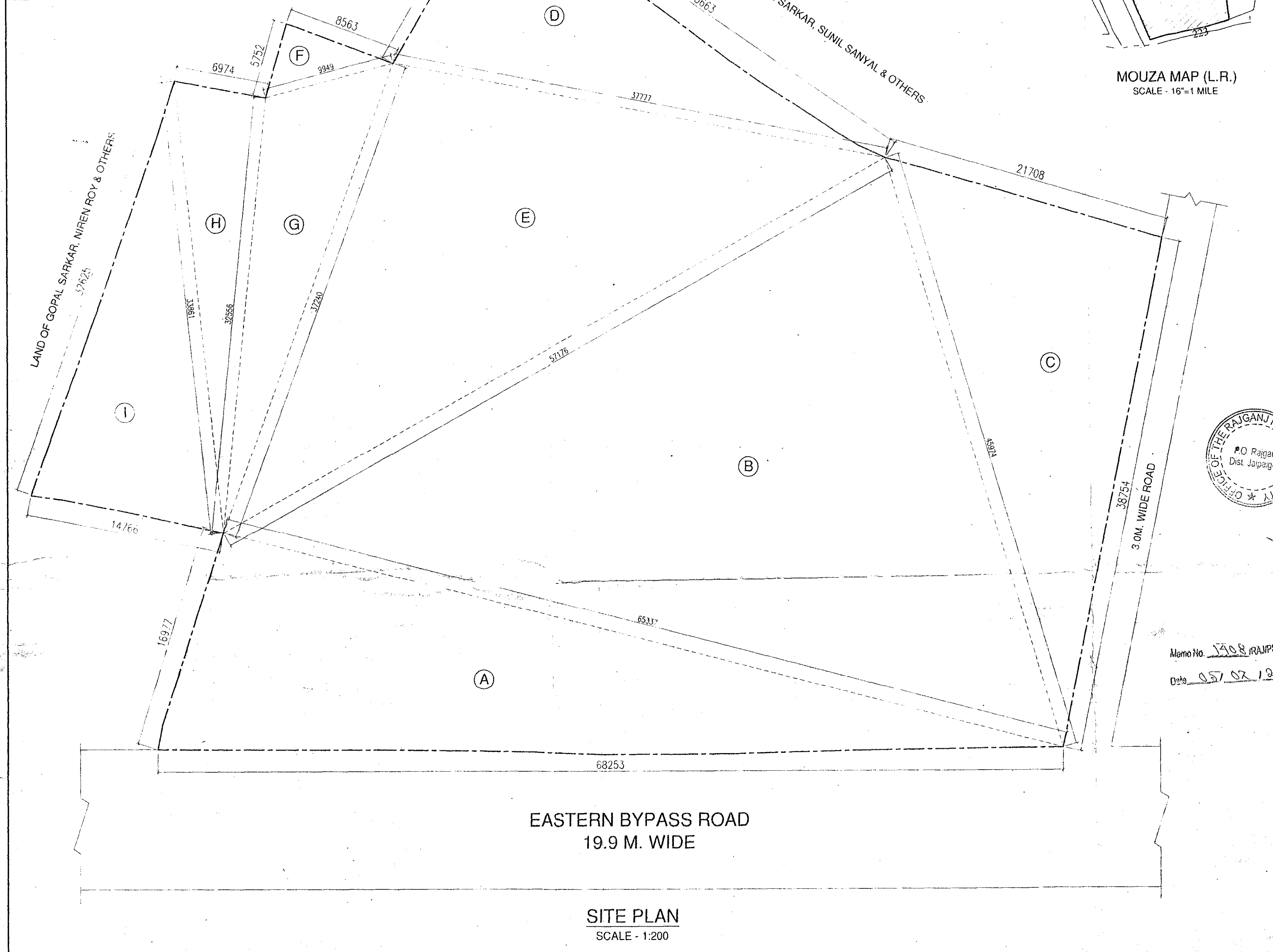

SITE PLAN SHOWING THE LAND OF PROP. LOWER GROUND + 5 STD. COMMERCIAL BUILDING AT EASTERN BYPASS ROAD, SILIGURI, DIST. - JALPAIGURI.

- NAME OF OWNERS :**
- 1) SRI. BAJRANG AGARWAL
S/O SRI BHAGWAN DAS AGARWAL
 - 2) SRI. KANHAYA LAL AGARWAL
S/O LATE P. USARAM AGARWAL
 - 3) SRI. RAM NIWAS GARG
S/O BHAGWAN DAS GARG
 - 4) SRI. RAKESH SINHAL
S/O SRI RADHESHYAM SINHAL
 - 5) SRI. PRAMOD KUMAR SINHAL
S/O LATE RAM KUMAR SINHAL
- ALL ARE REPRESENTED BY "D.M. VENTURES"
REP. BY ONE OF ITS PARTNER SRI. MRINAL AGARWAL,
S/O SRI. NARESH KR. AGARWAL

LAND SCHEDULE :

MOUZA	- DABGRAM
PLOT NO.	- 222 L.R., 203 R.S.
J. L. NO.	- 02
KHATIAN NO.	- L.R. 124, 125, 126, 127, 128 R.S. 200/19
SHEET NO.	- 13 R.S., 117 L.R.
PARAGANA	- BAIKUNTHAPUR
P. S.	- BHAKTINAGAR
DIST.	- JALPAIGURI

LAND AREA AS PER DEED	- 3747.39 SQ.M.
LAND AREA AS PER SITE	- 3747.01 SQ.M.
PERM. GR. COVERAGE	- 50% OR 1873.50 SQ.M.
PROP. GR. COVERAGE	- 49.95% OR 1871.65 SQ.M.
PROP. USE OF BUILDING	- COMMERCIAL

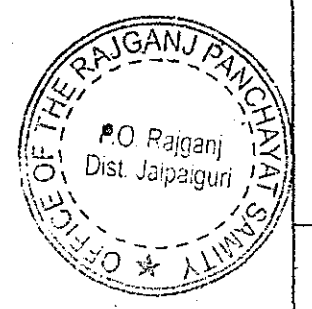
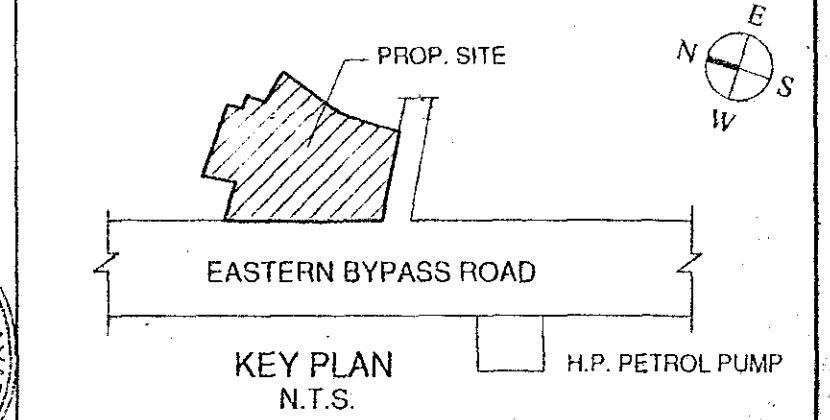

APPROVED: *[Signature]*
D.M. VENTURES
 Executive Officer
 Rajganj Panchayat Samity
 P.O. Rajganj, Dist. Jalpaiguri
 PARTNER

SIGNATURE OF OWNER

[Signature]
 S. Chakrabarty
 Sub-Assistant Engineer
 (B.P.C.)
 Rajganj Dev. Block
 Pritham Deo
PRITHAM DEY (B. Arch.)
 Counciling Architect
 CA/2006/39076
 SIGNATURE OF L.B.S./L.B.A.

TITLE -
L.U.C. SITE PLAN

DRAWN	SOURAV	SCALE	AS SHOWN
CHKD.	S. M.	SHEET NO.	01/05

Subrata Majumder
 Consultant Planner
Majumder & Associates
 Cont. - +91-9832082034, +91-9933575581